

Automation – Circular Weld Seams

TR-45 Welding torch rotation device



Productvideo



* The radius of rotation of the welding torch is between 100 and 450mm. The diameter of the flange or pipe, which is welded, is therefore 200 - 900mm.

Model	TR-45
Power	V1 : AC110V / 10A / 60Hz / 1Ø V2 : AC220V / 6A / 50;60Hz / 1Ø
Torch rotates the radius	100 - 450mm*
Torch speed	0.06 - 0.6RPM
The torch highly keeps	manual
Torch mounts X stroke	50 mm
Torch mounts Y stroke	100 mm
Control method	Inch/Hold
Stop the brake	Magnetism brake
Arc way of the welder	Standard(2 cycle)
Start the device	Pedal switch
Mountable Flange Specifications	flange inner diameter 166mm above

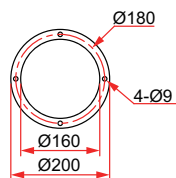
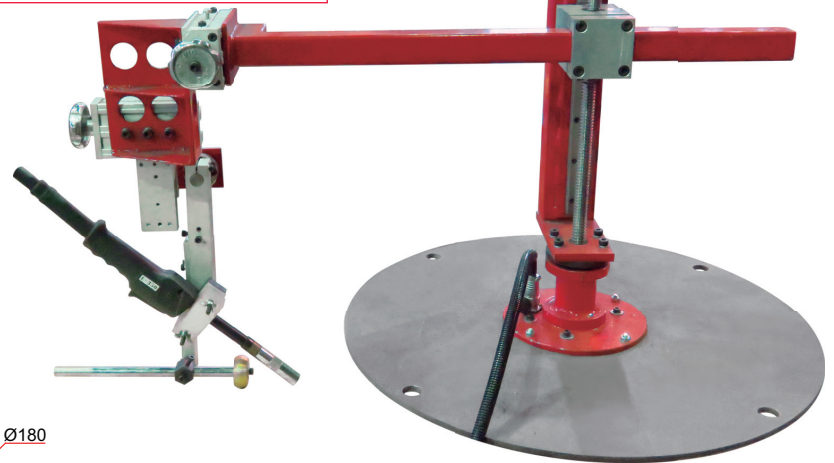

Unit:mm

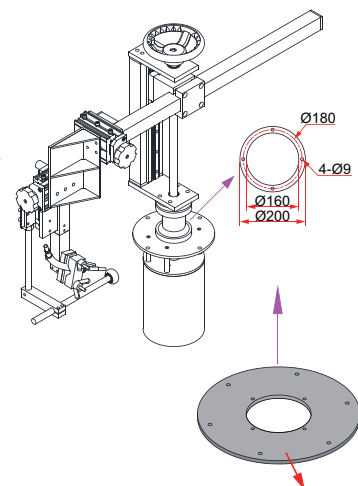
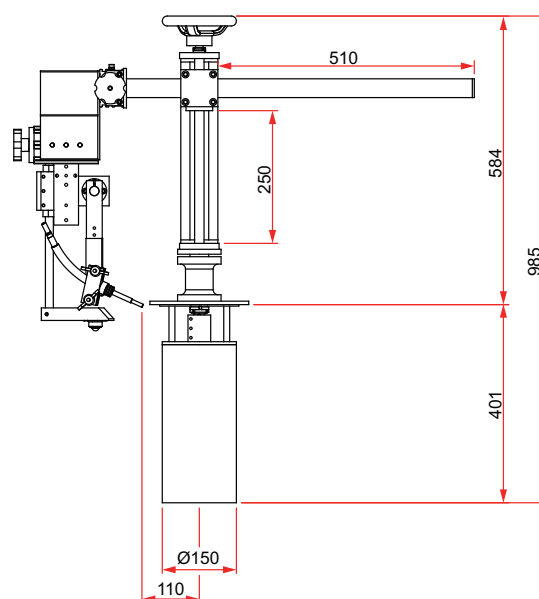

The operator can make the fixing plate according to the flange specification