

# Electrical Support

## Electric Linear Slide JC-MS

The slides with their robust aluminium housing are driven by DC 24 V stepping motor. A ball screw provides for a smooth drive in the inside.

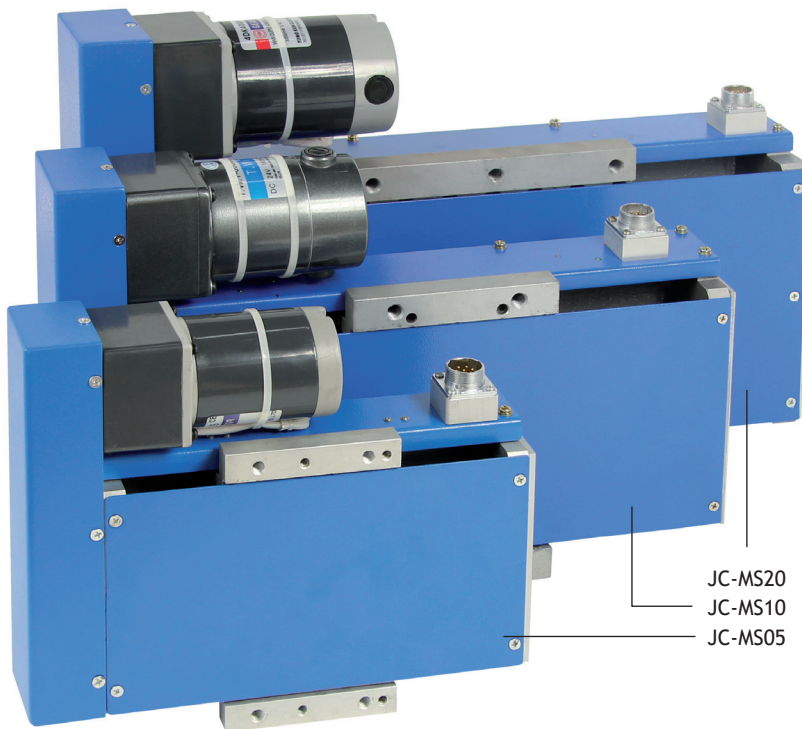

JC-MS20  
JC-MS10  
JC-MS05

### Features

- Backlash-free and extremely robust.
- Reliable and maintenance-free.
- Movement 100 – 200 mm.
- Load capacity 25 – 100 kg.

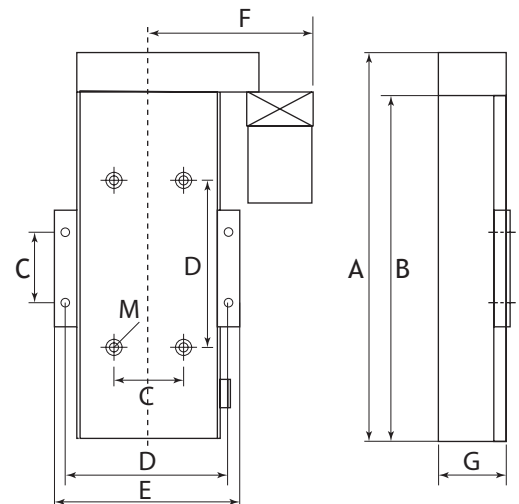

Model	JC-MS05	JC-MS10	JC-MS20	Meas.	JC-MS05	JC-MS10	JC-MS20
Stroke	100	200	200	A	278	414	489
Speed	20 - 250 mm/min.	20 - 250 mm/min.	20 - 200 mm/min.	B	238	374	444
Load	25 kg	50 kg	100 kg	C	60	76	164
Tolerance	+ - 0,1 mm	+ - 0,1 mm	+ - 0,1 mm	D	150	180	210
Input	DC24V	DC24V	DC24V	E	168	200	234
Weight	7,5 kg	11,5 kg	20,5 kg	F	152	178	205
Item no.	02.20.20.10100 (old: 72202305)	02.20.20.10200 (old: 72202310)	02.20.20.10210 (old: 72202320)	G	65	75	85
				M	8	10	10