

Stative

Torch Stand – BS-Series

Torch position BS-810M ,BS-810A, BS-121M and BS-121A

The torch stand BS-810M (manual) and BS-810A (pneumatic) is suitable for MIG torches, TIG torches and plasma torches.

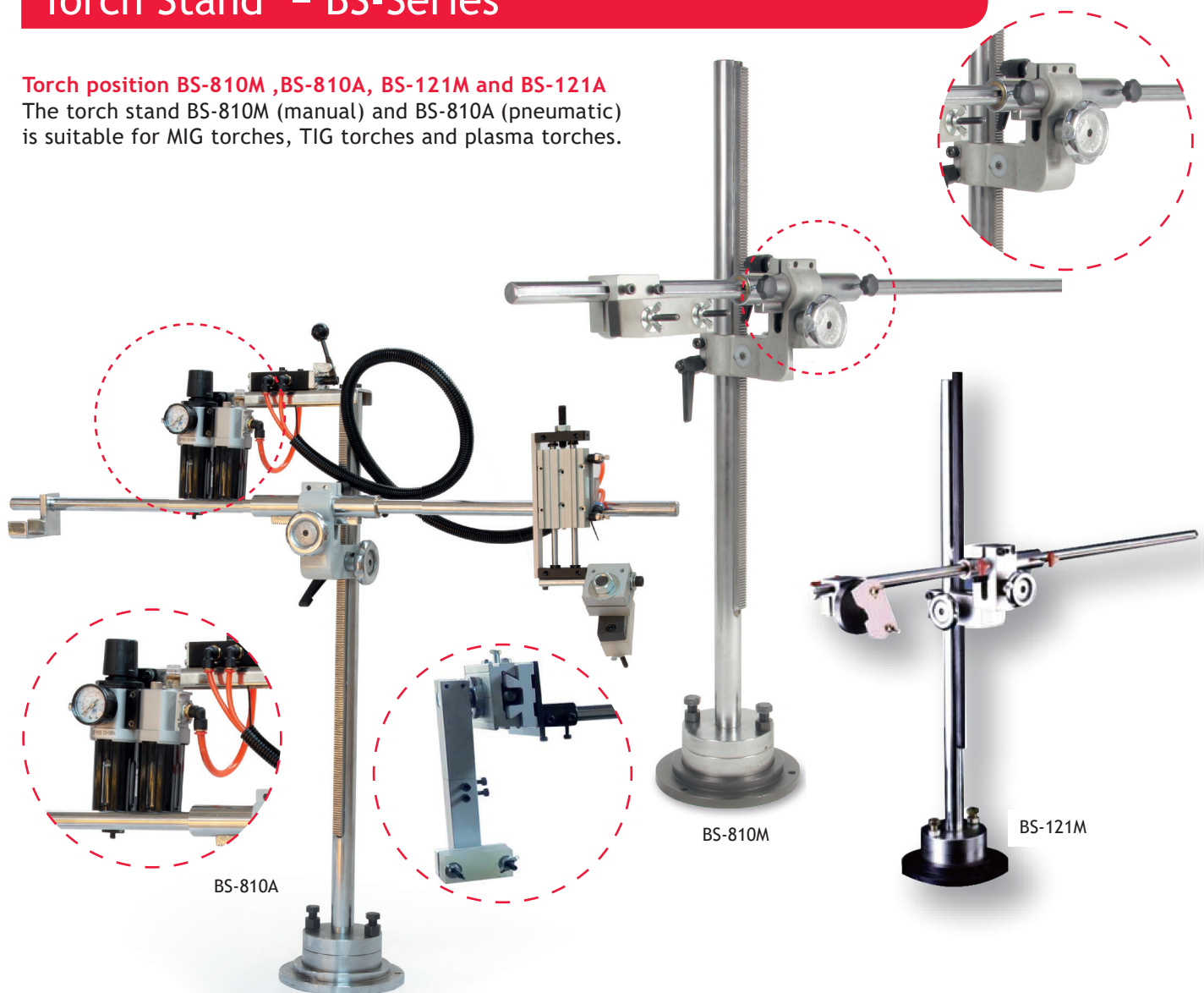

Model	BS-810M	BS-810A	BS-1210M	BS-1210A
Stand horizontal movement	700 mm		750 mm	
Stand horizontal operation	manually		manually	
Stand vertical movement	500 mm		850 mm	
Stand vertical operation	manually	manually	manually	manually
Stand angle of tilt	360°			
Max. load boom end	8 kg			
Torch angle of tilt	180°			
Torch Setting cylinder Stroke	none	50 mm	none	50 mm
Torch Setting Operation	none	manual pneumatic valve	none	manual pneumatic valve
Measur. (LxWxH) mm	960x230x815 mm	960x480x815 mm	960x230x1215 mm	960x480x215 mm
Total weight	18 kg	20 kg	23 kg	25 kg
Item no.	02.20.14.10110 (old: 71801118.BS810M)	02.20.14.10112 (old: 71801118.BS810A)	02.20.14.00210	02.20.14.00222
Optional	Torch slide (Item no.: 02.20.16.10077)			

Stative

Torch Stand – BS-Series

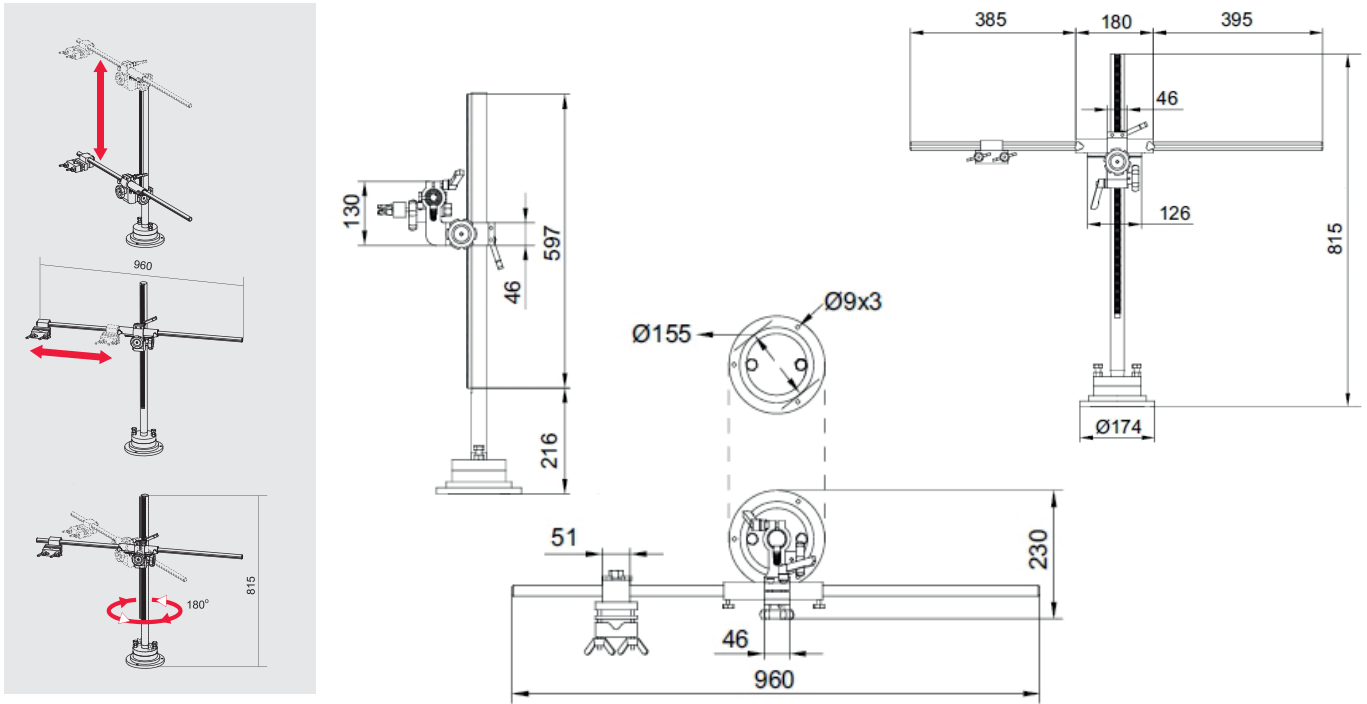

Torch Stand BS series suitable for 3D modular systems

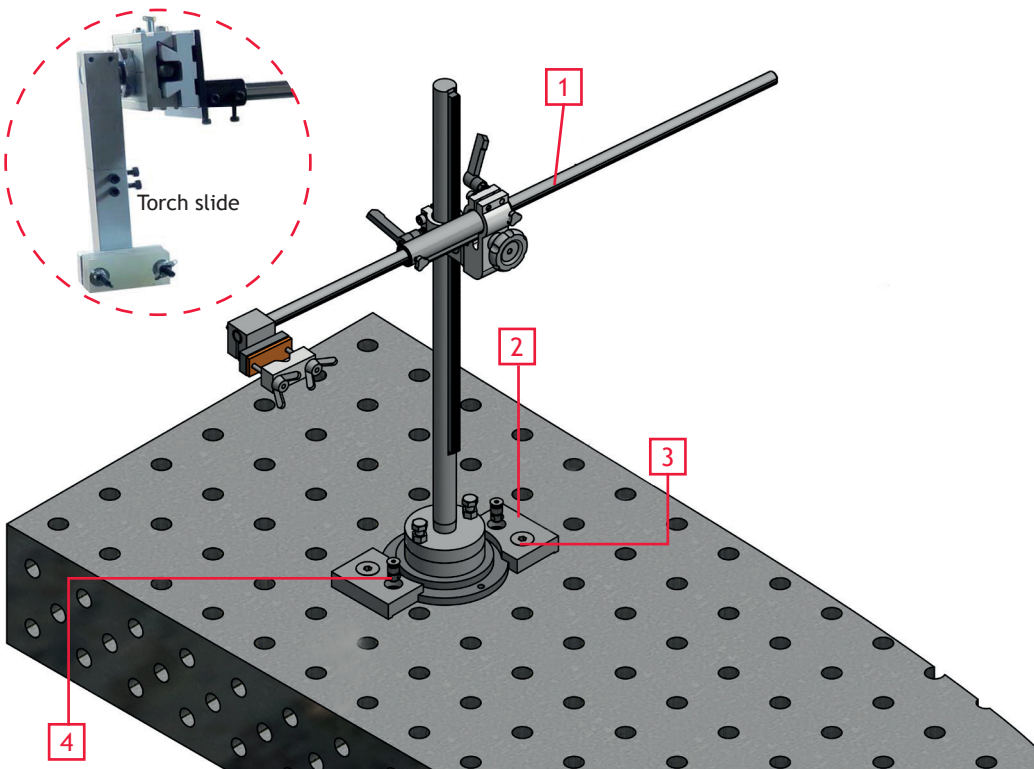

Pos.	Qty	Item 3D System 28 mm	Item no.	Pos.	Qty	Item 3D System 16 mm	Item no.
1	1	Torch Stand BS-810M	02.20.14.10110				
2	1	Depressor BS	02.32.02.18250				
3	2	Vertical head clamping bolt 28x50 mm	02.32.02.00010	4	2	Vertical head clamping bolt 16 x 24	02.32.02.00014